



Published : Nov 25, 2004

Power Steering Pressure Test - 4.4L

Special Service Tools

211-313

E58729

Adapter, power steering pressure test
211-313 (LRT-57-035A)

211-011-02

E58730

Hose, power steering pressure test
211-011-02 (LRT-57-002)

211-011-11

E58731

Hose, power steering pressure test
211-011-11

211-011-01

E58732

Valve block, power steering pressure test
211-011-01 (LRT-57-001)

211-287

E58733

Hose and gauge, power steering pressure test
211-287 (LRT-57-005)

211-325



E58734

Adapter, power steering pressure test
211-325 (LRT-57-042)

1 .



WARNING: Do not work on or under a vehicle supported only by a jack. Always support the vehicle on safety stands.

Raise and support the vehicle.

2 . Disconnect the battery ground cable.

[Specifications](#)

3 . Remove the radiator access panel.

- Remove the 4 bolts.

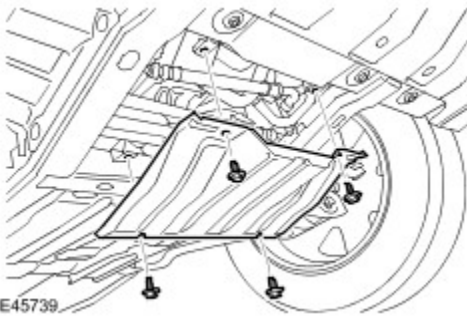

E45739

4 . Remove the front LH splash shield.

- Remove the 4 clips.

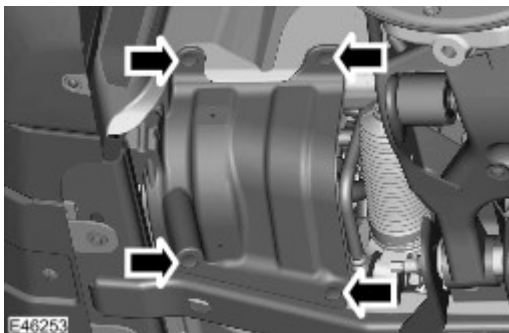

E46253

5 . Siphon the fluid from the power steering reservoir.

- Remove the filler cap.
- Install the filler cap.

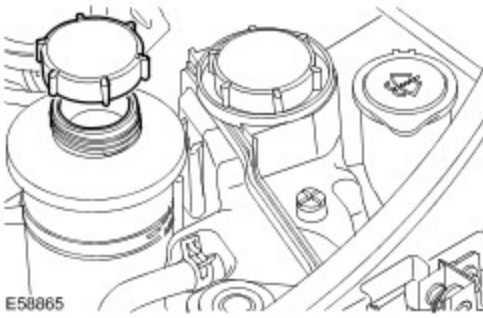

6 . Position an absorbent cloth to collect fluid spillage.

7 .



CAUTION: Before disconnecting or removing the components, ensure the area around the joint faces and connections are clean. Plug open connections to prevent contamination.

NOTE :

Some fluid spillage is inevitable during this operation.

NOTE :

Care must be taken to avoid contamination of the drive belt.

Disconnect the power steering high-pressure pipe union.

- Remove the bolt.
- Remove and discard the 2 sealing washers.
- Position a container to collect the fluid.

8 . Install the special tools to the power steering high-pressure port.

- Install the O-ring seal.
- Tie the pressure gauge aside under the hood.

9 . Install the special tool to the high-pressure union.

- Install the O-ring seals.
- Connect the special tool line, to the special tool valve block assembly.

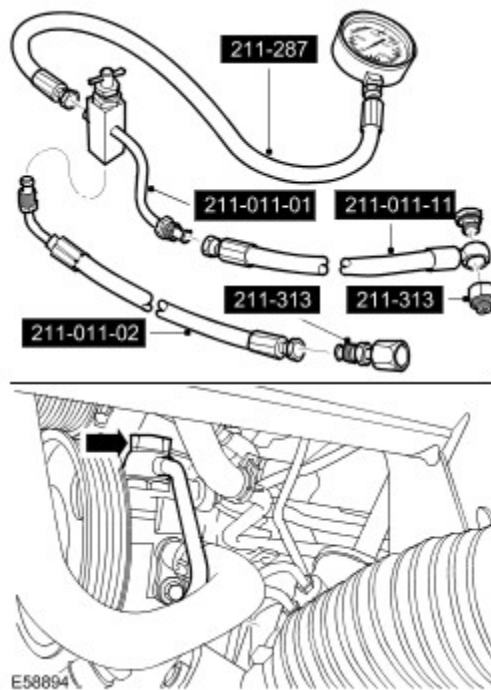

10 . Refill the power steering reservoir.

- Remove the filler cap.

11 . Connect the battery ground cable.

[Specifications](#)

12 . **NOTE :**

Ensure the steering components and test equipment are free from leaks.

NOTE :

Maintain the maximum fluid level during the test.

NOTE :

Make sure the steering is in the straight ahead position.

NOTE :

Under no circumstances must the low pressure spigot be removed from the steering pump.

With the test valve open start the engine.

- Start the engine and turn steering fully lock to lock, stop the engine.
- Top-up the power steering fluid reservoir.
- Install the reservoir filler cap.

13 . For correct power steering pressures, refer to the steering specification section.

[Specifications](#)

14 . With the engine at idle, slowly turn the steering wheel and hold on full lock.

- Record the pressure reading.

- 15 . Repeat the above procedure for the other side.
 - Record the pressure reading.
- 16 . With the engine at idle, release the steering wheel. The pressure should be, at or below, the pressure specified.
 - Pressure outside this tolerance, indicates a fault.
- 17 . To determine if the fault is in the steering pump or the steering rack, close the test valve for a maximum of 5 seconds.
- 18 . If the pressures recorded fall outside the given values, replace the power steering pump.
- 19 . If the maximum pump pressure is correct, then suspect the power steering rack.
- 20 . On completion of the test stop the engine, disconnect the battery ground cable and siphon the steering fluid from the reservoir.
 - Remove the filler cap.
 - Install the filler cap.
- 21 . Disassemble the test equipment.
- 22 . Connect the high-pressure line to the power steering pump.
 - Clean the component mating faces.
 - Install the new O-ring seals.
 - Tighten the bolt to 25 Nm (18 lb.ft).
- 23 . Install the front LH splash shield.
 - Secure with the clips.
- 24 . Install the radiator access panel.
 - Tighten the M6 bolts to 10 Nm (7 lb.ft).
 - Tighten the M10 bolts to 45 Nm (33 lb.ft).
- 25 . Connect the battery ground cable.
- 26 . Refill and bleed the power steering.
[Power Steering System Filling and Bleeding](#)